

Table of contents

Introduction	3
What is the intended use for mē? _____	3
mē system _____	4
Important safety information _____	7
When not to use the mē /contraindications _____	7
Warnings _____	9
Possible side effects and skin reactions _____	10
How to use your mē system _____	11
Skin sensitivity test _____	12
Treating with mē _____	12
Clean and store mē _____	19
Post-treatment care _____	20
How to replace your elōs cartridge/ shaver/ epilator/ Face adaptor _____	21
Travel with mē _____	23
Troubleshooting _____	23
Guarantee and service _____	25
Manufacturer Information _____	26
Contact information _____	29

introduction

Congratulations on purchasing your mē system! mē is an innovative device that can be used in the comfort and privacy of your own home to permanently remove unwanted hair.

mē is the only at-home permanent hair removal device to use patented elōs technology and is clinically proven to be safe and effective for all skin tones. Gentle, easy to use and just minutes a treatment, now you can experience the freedom of silky, smooth skin without the hassles of shaving and waxing.

Before using mē, visit our web site at www.mepower.com and make sure to register your me and watch our demonstration video.

what is the intended use for mē?

Skin Tone

mē is intended for use on the body and face on ALL skin tones (skin color you are born with).

Body and face:



Hair color

mē is intended for use on the widest range of hair colors.

Note: For effective results, the epilator attachment is recommended for body treatment of naturally light blond, red and white/grey hair. The epilator attachment should not be used on the face

what is the intended use for mē?

Body areas

mē is intended for use by women and men on body hair below the neck and by women for facial hair below the cheek line.

Note: Facial treatment is different than body treatment.
Ensure you read the entire user manual before getting started

mē system

your mē package includes:

- mē system powered by elōs technology
- one elōs cartridge (already installed)
- accessory protective cap (already installed)
- elōs protective cap
- power cord
- User manual including a quick reference guide
- warranty card
- protective eyewear

additional mē accessories:

Sold separately or included with your mē system

- shaver
- epilator
- face adaptor
- replacement elōs cartridge
- pouch for storage

For more details about accessories, go to www.mepower.com.

mē system

device components (Figure 1):

1. base unit.
2. cradle.
3. control panel with:
 - ① power button
 - elōs energy setting buttons with 3 energy levels: Low- Medium- High
 - 🗉 empty indicator shows when the elōs cartridge is finished and needs to be replaced
 - ⏏ accessory activation button
4. applicator (hand piece with cord).
5. elōs cartridge with light output window and RF contact bars.

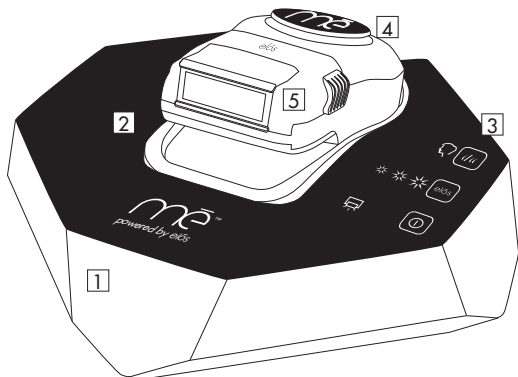

Figure 1: mē system

mē system

applicator components (Figure 2):

6. light output window.
7. RF silver contact bars (Both RF silver bars must be in complete contact with the skin for the light pulses to flash).
8. elōs cartridge: comes attached to the applicator and is preloaded with elōs pulses. You will need to replace the cartridge when the Empty indicator light on the base unit is red.
9. elōs activation button.
10. cooling outlet.
11. accessory protective cap.*

*If you don't have a replacement cartridge – make sure you place the elōs protective cap instead of the used cartridge. This is in order to protect the inner parts of applicator.

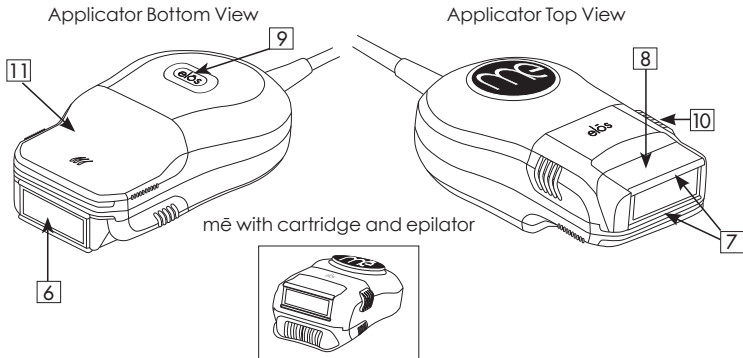

Figure 2: Top and bottom view of applicator

important safety information



This symbol appears next to information about possible safety risks.

The mē system is not designed for everyone. Please read this user manual before using the mē system. Make sure you follow all the warnings. Don't use the device if it isn't right for you (see Contraindications section below). If you do not understand any of the warnings or have any questions, please contact Customer Service at www.mepower.com.

when not to use the mē /contraindications



DO NOT use if the skin, in the area you want to treat, is tanned or burned.

DO NOT use if your skin was tanned due to sun exposure, tanning beds or tanning creams in the past 2 weeks. Use of the device on tanned or burned skin may result in temporary or even permanent whitening or darkening of the skin. If you are unsure if your skin is tanned or burned,

DO NOT use the device for the next 2 weeks. During these 2 weeks,

DO NOT expose the area you intend to treat to the sun.



DO NOT use if you are pregnant, trying to become pregnant (conceiving) or breast-feeding. mē has not been tested on pregnant or breast-feeding women.



DO NOT use if you have epilepsy or light-induced seizures or migraines. The energy flashes might cause severe headaches and migraines.



DO NOT use on tattoos, dark brown or black spots (such as dark freckles, birthmarks, moles or warts). Tattoos or dark spots may absorb too much light energy which could cause skin swelling, temporary or permanent blisters or discoloration of the skin or whitening of the skin.



DO NOT use around the eyes, on the head, ears, nipples, genitalia, or around the anus. Use in these areas could cause skin swelling, blisters, or temporary skin discoloration or whitening of the skin.



DO NOT use if you are under the age of 18. The effects of using mē in this age group are unknown.

when not to use the mē /contraindications



DO NOT use if you have any skin condition in the treatment area, including acne, sores, psoriasis, eczema, burns, herpes simplex, wounds or a rash. These conditions can make the skin more sensitive to the light treatment and could make the treatment uncomfortable or cause skin swelling, blisters or infection. Wait for the affected area to heal before using. If you are not sure if your skin condition has healed enough to use the device, then please consult with your doctor.



DO NOT use the device if you have a history of keloidal scar formation, a known sensitivity to light (photosensitivity) or are taking medication that makes the skin more sensitive to light, including non-steroidal anti-inflammatory agents, (e.g., aspirin, ibuprofen, acetaminophen), tetracyclines, phenothiazines, thiazide, diuretics, sulfonamides, DTIC, fluorouracil, vinblastine, griseofulvin, Alpha-Hydroxy Acids (AHAs), Beta-Hydroxy Acids (BHAs), Retin-A, Accutane and/or topical retinoids.



DO NOT expose treated areas to the sun during the entire treatment period. Wait at least 2 weeks after the final treatment before you expose treated skin to the sun or tan with artificial light. Even after 2 weeks, make sure that the treated skin is not red from the treatment before you expose it to the sun. Be sure to carefully protect the treated skin with sunscreen throughout the hair removal period. Failure to follow this warning could result in skin swelling, blisters, temporary or permanent skin discoloration or skin whitening.



DO NOT use if you have an active implant, such as a pacemaker, incontinence device, insulin pump, etc. Use of the mē system has not been tested in individuals with active implants, and, therefore, the effects are unknown.



DO NOT use if you have been treated with Accutane® (isotretinoin) within the past 6 months. This can make the skin more sensitive to the light treatment and could make the treatment uncomfortable or cause skin swelling, blisters or infection.

warnings



DO NOT open the outer covers of the mē device or the cartridge or touch any inner parts. This is for your safety. Do not attempt to repair your mē device. Trying to open the mē may also damage the device and will void your warranty. Please contact Customer Service on www.mepower.com if you have a broken or damaged device in need of repair. Failure to follow these warnings can cause electrocution or electric shock.



DO NOT use the mē system in the sink/bath/shower or where it can come into contact with liquids or become wet. This can cause electric shock. If the system is dropped into liquid, unplug it immediately. Do Not remove the system from the liquid until unplugged. Do Not use the system again and contact Customer Service.



DO NOT hold the applicator window still over one spot on the skin and flash multiple light pulses on the skin. Doing so may cause too much heat and may result in skin swelling, blisters, or temporary or permanent changes in the color of your skin. After each flash, move the treatment window slowly to a neighboring skin spot. Before returning to a previously treated skin spot, wait for at least 10 seconds.



DO NOT use mē if any parts show signs of damage. This may result in injury.



DO NOT cover any ventilation slots during use, as they help to keep the device cool during operation. Covering the ventilation slots could result in device overheating.



KEEP OUT OF REACH OF CHILDREN! mē is a powerful device and should not be used by anyone under the age of 18.



DO NOT leave mē unattended around children, as the cords represent a choking hazard. Children should be supervised to ensure that they do not play with the appliance.

warnings



DO NOT use if your skin is sensitive to light. This condition could make the light treatment uncomfortable or cause skin swelling, blisters or infection. In order to determine if you can use mē, perform a test on a small patch of skin. Then, wait 30 minutes to see if any skin reactions developed. Only if no skin reactions developed and the skin looks normal, you may use mē. See steps for testing on page 12.



DO NOT use mē on any area where you may want your hair to grow back.



DO NOT use the system in room temperature above 86°F (30°C). If the system heats up, it may not work properly and may cause injury.

possible side effects and skin reactions

Use of mē could result in possible side effects.

These reactions are rare and should resolve within a short time.

However, every cosmetic treatment may involve some degree of risk.

With any of the reactions stated below, make sure to stop the treatment and to consult with your doctor: color or textural changes to the skin that may be permanent, substantial redness of the skin, itching of the treated area, acne outbreak, blistering or burning of the skin, permanent scarring or loss of skin tissue or if unusual pain occurs.

how to use your mē system

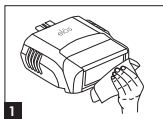

1

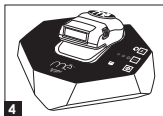

4



6



8

setting mē up

1. Clean the cartridge light output window with a non-alcohol based wet wipe or soft tissue. This is done in order to remove hairs and dust from the treatment window.
2. Connect the power cord into the mē system.
3. Place the mē system on a table or area near an electrical wall outlet. Move away any liquids from the area.
4. Make sure the applicator is placed in its cradle before turning on the mē.
5. Connect the power cord to the wall electrical outlet.
6. Press the power button to turn the system on. Wait until the indicator light on the power button turns green. Now the system is ready for use.
7. Set the desired energy level Low, Medium or High.
8. The cartridge is pre-loaded with pulses for your use. When the Empty indicator starts blinking, it means that there are only limited pulses left in your cartridge and you should prepare a new one. When the Empty indicator is on, you should replace your cartridge.

Note: Start with LOW elōs level, if you feel comfortable, you may increase the elōs level for better results

skin sensitivity test

If you are using the system for the first time or in new body area, choose a small area close to the area you intend to treat, for the purpose of performing a skin sensitivity test. Use the LOW elōs level. Follow the treatment instructions below but make sure to emit only 2-3 pulses. After the skin test, wait 30 minutes and check your skin for any reaction. If after 30 minutes the skin appears normal, then you are ready to perform a full treatment.

treating with mē

Body:

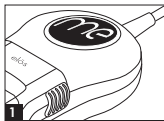

Step 1. For your convenience, you can use the mē epilator or shaver accessories to remove hair. If you do so, there is no need for preparations before the treatment, only make sure the hair is no longer than 0.5 cm. Remove the protective cap, and insert the epilator or shaver cartridge instead. If you do not use the designated mē system shaver or epilator accessories, shave any hairs with a razor or electric shaver. Make sure that the protective cap (provided) is inserted. The system will not work if the protective cap or epilator/shaver accessory is not in place.



Step 2. Clean your skin and dry it with a towel.

Step 3. Press the elōs button on the base to select the appropriate elōs level (Low, Medium or High). Press the elōs button again to move from Low to Medium and again to move from Medium to High. In order to return to the Low setting you must press the elōs button again.

It is recommended to start on Low and move to a higher elōs level if you feel comfortable.

treating with mē



4

Step 4. If you use the designated shaver/ epilator, press the accessory activation button on the control panel once to run the epilator mechanism at low speed. If desired, press it again to run the epilator at high speed. The shaver cartridge operates only at Speed Level 1.



6

Step 5. Remove the applicator from the base.

Step 6. Press the elös activation button located on the applicator. You will hear the fan inside the applicator.

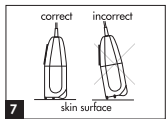

7

Step 7. Gently place the applicator on your skin, so that the two RF silver contact bars are in complete contact with the skin. The mē will emit pulses.

Note: The applicator will not work unless both RF silver contact bars are touching the skin

Step 8. After every flash, glide the applicator slowly to the next neighboring spot over the skin by moving it in one continuous, slow motion.

Note: The applicator will automatically turn itself off if it is not in use for 30 seconds. To turn the applicator back on, press the elös activation button located on the applicator

DO NOT hold the applicator window still over one spot on the skin and flash multiple light pulses on the same spot on the skin. Doing so may cause too much heat to build up and may result in skin swelling, blisters, or temporary or permanent changes in the color of your skin. After each flash, move the applicator to a different skin spot.

Wait for at least 10 seconds before returning to a previously treated skin spot.

treating with mē

Step 9. For effective results, mē should be used according to the treatment times indicated below. The minimum treatment times recommended below may vary person to person. We recommend to see that each treatment area is covered by 2-3 pulses:



2 minutes



1 minute
per underarm



2 minutes
per bikini area



3 minutes
per arm



10 minutes
per full leg



2 minutes
per shoulder



5 minutes
per abdomen

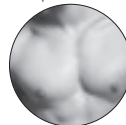

6 minutes
per chest



12 minutes
per back



Tips: When using the system on difficult-to-treat areas (e.g. underarm) apply the applicator in 2 directions: left/right and up/down for full coverage.

You can treat all body areas during the same treatment session.

Guidelines for treatments

It is normal to still see hairs after the first few treatments. For best results, the treatments should be performed once a week for the first 7 times. Performing additional monthly maintenance treatments, after the first 7 treatments, will help your hair removal results last longer.



treating with mē

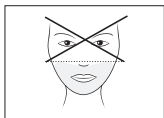

Face:

Removing unwanted hair from the face is very different from removing unwanted hair from other parts of the body. The mē device is intended to remove facial hair from the cheek line downward, including the mustache/upper lip, sideburns, jawline and chin/upper neck areas. The mē device is not intended to treat eyebrows, nose hairs or hair in the ears. Please be sure to read this section thoroughly before starting to remove facial hair with your mē. When treating facial hair, it is recommended to use the face adaptor. The face adaptor has been designed to accommodate for smaller and more delicate treatment areas

on the face. When the face adaptor is attached to your applicator, it delivers energy in single pulse mode at the desired energy level. The face adaptor can be purchased with the mē or separately as an accessory. Face adaptor design may change.

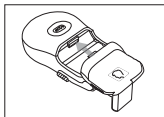

Skin Tone

mē is suitable for all skin tones.

Face:



When treating the face, use mē twice a week for 2 weeks.

Then perform additional treatments every two weeks to help results last longer.



general information about facial hair removal

The hair on the face differs from other body areas in its physiology. Its growing cycles are different, and its characteristics, such as thickness, color and depth of follicle are different from body hair. The face is more sensitive to hair removal due to sensitivity of nerves in some of its areas. The skin on the face and neck is more likely to be exposed daily to the sun's UV radiation and, therefore, may be more sensitive than other parts of your body.

treating with mē

Note: For men it is not advisable to treat the beard as it might create uneven results, which may produce changes in facial characteristics that may not be desirable

when you should not use mē on the face



If your facial skin is sunburned or tanned, wait until the sunburn or tan fades prior to performing a test pulse on a hidden area (i.e. under the chin). Evaluate the area after 3 days to ensure no side effects have occurred and only then start treatment.



If you have undergone any professional facial treatment (such as a chemical peel, laser/light/radio frequency treatment or injected dermal fillers) within the past 3 months, please consult with your doctor.



If you have undergone any facial surgery (such as face lift, facial implant) within the last three months or before complete healing, please consult with your doctor.



If you are taking any medications that cause sensitivity to the sun or have a history of any skin disorders, consult with your doctor before using mē on the face or any other body area.

Please refer to the general list of Contraindications in the beginning of this User manual.

warnings



DO NOT use above the cheek line.



DO NOT use the epilator or shaver accessories when using mē on the face.



DO NOT expose treated areas to the sun during the entire treatment period. Wait at least 2 weeks after the final treatment before you expose treated skin to the sun or tan with artificial light. Even after 2 weeks, make sure that the treated skin is not red from the treatment before you expose it to the sun. Be sure to carefully protect the treated skin with sunscreen (at least SPF 30)

treating with mē

throughout the hair removal period. Failure to follow this warning could result in skin swelling, blisters, temporary or permanent skin discoloration or skin whitening.



DO NOT treat the eye socket or around the eye area.



DO NOT use for eyebrow shaping! It is important to avoid accidentally treating the eyebrows as any hair loss is likely to be permanent.



DO NOT treat the beard area in men. This might create undesirable hair removal results.



DO NOT treat over moles or birth marks. Protect small areas of sensitive skin such as moles, birthmarks, etc. by using a white eyeliner. For larger areas of sensitive skin, use a piece of cardboard or thick paper to cover the affected area and prevent exposure to the treatment. Protect lips and the lip margin using a white eyeliner.



DO NOT treat tattoos or permanent makeup.



DO NOT treat the scalp.



DO NOT treat inside the nostrils or ears as these areas are delicate. Avoid treating areas that contain only vellus hair (very thin, fine hair, also called "peach fuzz"), as this may result in undesired hair re-growth. In the very unlikely event that you see pigmented changes on your face, please stop the treatment and consult with your doctor.



DO NOT use perfumed products or makeup, for several hours after a treatment, as this may cause slight irritation. If unusual pain occurs during treatment, you should stop treatment immediately. Temporary skin redness may occur up to 24 hours after treatment. If the symptoms persist more than 24 hours, and/or you feel significant discomfort and/or encounter any severe side effects, discontinue treatment and consult with your doctor.

treating with mē

How to use:

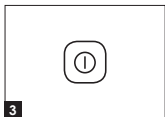

3

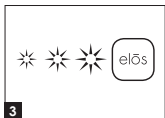

3

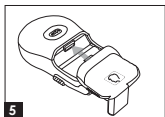

5



6

1. Clean your skin and remove the hair on the surface of the skin. You may remove the hair on your face with tweezers, wax, shaver, etc. but not with an epilator.

2. Use a broad ambient light environment. Turn on your mē device. Select the LOW elös level on the base unit. The device will not work if you do not select an elös setting.

3. Put on the provided eye goggles or sunglasses. Eye protection is recommended as treating near your eyes may cause temporary discomfort.

With a face adaptor*

4. Remove the accessory protective cap and connect the face adaptor. The face adaptor will allow the system to emit only single pulses with the desired energy level.

5. Press the elös cartridge activation button on the applicator to turn on the applicator. Gently position the applicator on the area you want to treat. Press once the elös activation button to emit a single pulse.

6. Reposition the applicator on the next area to be treated and press the elös activation button again to emit another pulse. Repeat these previous steps until you have covered the entire facial area. Wait at least 10 seconds before you treat over the same spot.

Without a face adaptor

4. Press the elös activation button on the applicator to turn on the applicator. Gently position the applicator on the area you want to treat. Upon contact - a pulse will be emitted. Remove the applicator after a single pulse.

5. Reposition the applicator on the next area to be

* Sold separately or included with your mē system

treating with mē

treated, another pulse will be emitted, remove the applicator after a single pulse. Repeat these previous steps until you have covered the entire facial area. Wait at least 10 seconds before you treat over the same spot.

Note: Always start with LOW elōs level. If you feel comfortable, you may increase the elōs level for better results

clean and store mē

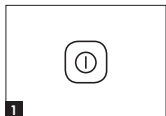

1

1. Turn off the system by pressing the power button on the base unit.

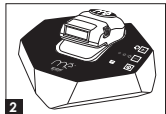

2

2. Place the applicator in its cradle on the base unit and unplug the electric cable from the electrical outlet.

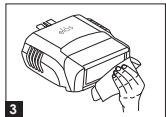

3

3. Clean the cartridge light output window with a non-alcohol based wet wipe or soft tissue.

4. If you have used the designated mē epilator or shaver: Remove the shaver or epilator from the applicator and place the protective cap instead. Use a cleaning brush to clean the accessories. It is recommended to use a soft tissue or a non-alcohol wet wipe for cleaning.

5. If you have used the designated mē face adaptor: Remove the face adaptor from the applicator and place the protective cap instead.

Clean the outside surface using ONLY a dry soft cloth or a non-alcohol based wet wipe.

clean and store mē

6. Clean the outside surface of the mē system using **ONLY** a dry soft cloth or a non-alcoholic based wet wipe.
7. Store the system in a cool and dry place **AWAY** from the reach of children.

post-treatment care

Gently rinse your skin with lukewarm water and pat dry.



Do not expose treated areas to the sun. Wait at least 2 weeks after treatment before you expose treated skin to the sun or tan with artificial light. Even after 2 weeks, make sure that the treated skin is not red from the treatment before you expose it to the sun. Be sure to carefully protect the treated skin with sunscreen throughout the hair removal period. Failure to follow this warning could result in skin swelling, blisters, temporary or permanent skin discoloration or skin whitening or darkening.

how to replace your elōs cartridge/shaver/ epilator/face adaptor

Visit our web site at www.mepower.com in order to buy a replacement cartridge, epilator, shaver or face adaptor.



When the Empty indicator starts blinking it means that your elōs cartridge is almost empty and it is time to purchase a new one. When the indicator is constantly on, it means that the cartridge is empty and you need to replace it.

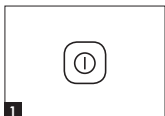

1

Replacing your elōs cartridge:

1. Make sure that the mē system is turned off and the cable is unplugged from the electrical wall outlet.

2. Remove the used cartridge from the applicator by holding both sides of the cartridge and gently pulling it out.



2

3. Take the new cartridge out of its protective container. Avoid touching the glass. Fingerprints or oils from your skin interfere with light passing through the glass, and this will reduce the treatment success.

4. Slide the new cartridge gently into the applicator until you feel it "clicks" into place.

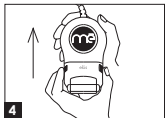

4

5. Place the applicator in the cradle of the base unit before turning on the mē system.

6. Turn on the mē system.

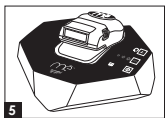

5

how to replace your elōs cartridge/shaver/ epilator/face adaptor



1

Replacing your designated mē shaver, epilator or face adaptor:

1. Make sure that the mē system is turned off and the cable is unplugged from the electrical wall outlet.

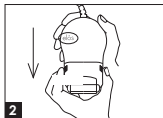

2

2. Remove the protective cap from the applicator by gently pulling it out.



3

3. Take the shaver, epilator or face adaptor out of its protective container. Slide it gently into the applicator until you feel it "clicks" into place.

4. Place the applicator on the cradle of the base unit before turning on the mē system.

5. Turn on the mē system.

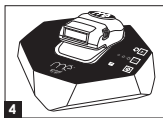

4

Disposal of used cartridges

Step 1. If you don't have a new cartridge, make sure you place the protective cap in place of the used cartridge to protect the system inner parts.

Step 2. Please follow the regulations where you live for disposal of electric systems when recycling or disposing of your base unit, hand piece or disposable cartridge. If you have questions, please contact us at www.mepower.com.



Waste Electrical and Electronic Equipment (WEEE)

travel with mē

The mē system is designed with universal voltage. That means that you can use the system all over the world. You will need to use an adaptor for the plug, since electric wall outlets vary by country. Make sure that mē system does not get wet while traveling. Do not use it in a wet environment. It is recommended to protect your mē device while traveling. A travel bag may be purchased separately at www.mepower.com.

troubleshooting

Indicator	What does it mean	How to react
Device		
No lights are on	Power cable is not connected	Connect power cable
All eiōs energy setting buttons are blinking (High-Medium-Low)	No eiōs energy level was selected	Select an eiōs level. The applicator fan will start blowing indicating that the cartridge is active
eiōs activation button on the applicator is blinking	eiōs energy level was selected but eiōs activation button was not pressed yet	Press the eiōs activation button. The applicator fan will start blowing indicating that the eiōs cartridge is active
Power button is blinking in orange color	An error had been detected	Reset the system by turning it off and on again. If problem persists, disconnect power cord and wait until all lights are off (several seconds). Then reconnect the power cord and turn on system. If error light is still on, try moving to a cooler area with a room temperature of less than 30°C/ 86°F and restart the system
No flashes are coming out	<ol style="list-style-type: none"> 1. RF silver skin contact bars not in contact with the skin in treatment area 2. eiōs activation button is not pressed or eiōs energy level was not selected 	In order for the system to flash pulses, make sure all 3 conditions are met: eiōs level selected, eiōs activation button is pressed, RF silver skin contact bars are in contact with skin

troubleshooting

Indicator	What does it mean	How to react
eIōs energy button on base is flashing	Cartridge slot is empty	Insert cartridge or a protective cap
Accessory activation button on base is flashing	Accessory slot is empty	Insert face adaptor, or accessory (shaver/epilator), or a protective cap.
Empty cartridge level indicator is blinking	Amount of pulses remaining in eIōs cartridge is low	Prepare a new cartridge to be in-hand
Empty cartridge level indicator is constantly on	No more pulses remaining in eIōs cartridge	Insert a new eIōs cartridge
Other		
My skin is red after treatment	The skin may become red as a result of the treatment. This redness generally clears up within 24 hours	If the redness persists more than 24 hours after a treatment, stop using mē and contact your doctor or Customer Support
I barely see any hair reduction	Make sure to follow the protocol suggested and to use the treatment duration time suggested	Actual results will vary from person to person, depending on the body area being treated and whether the instructions were followed correctly. Contact Customer Support for help
I feel some warmth when I apply the light flashes. Is this normal?	You may feel warmth, tingling, or itching. It is expected that this discomfort and warmth will be up to moderate	If the discomfort is severe/intense or persists for more than 24 hours after a treatment, stop using the mē and contact your doctor or Customer Support

If you still have problems with the mē system, contact Customer Support at www.mepower.com.

guarantee and service

Note: if you received a Warranty note from your local distributor – it will prevail over the below warranty terms

Your mē device is warranted to be free from defect in material and workmanship for a period of one year (or otherwise as stated by your local distributor) from the original purchase date under normal use. The cartridge warranty is for 3 months from the purchase date or 50% usage – whichever comes first. This warranty extends only to the original retail purchaser with original proof of purchase and only when purchased from an authorized mē retailer or reseller. If the product should become defective within the warranty period, contact us at www.mepower.com or your local distributor.

luminage Beauty Ltd. ("luminage ") reserves the right to replace a defective product with the most comparable product currently available. Your exclusive remedy for any defective product covered by this limited warranty is limited to the repair or replacement of the defective product. luminage 's entire liability for any defective product shall in no event exceed the original purchase price of the defective product.

This warranty does not cover products determined by luminage to be damaged by any of the following: accident, misuse, abuse or alteration, servicing by unauthorized persons, use with unauthorized accessories or use other than as instructed, connecting to incorrect current and voltage and/or any other conditions beyond luminage 's control.

TO THE EXTENT PERMITTED BY LAW, luminage SHALL NOT BE RESPONSIBLE FOR ANY DIRECT OR INDIRECT DAMAGES RESULTING FROM THE USE OR MISUSE OF THIS PRODUCT INCLUDING ANY GENERAL, INCIDENTAL, SPECIAL, OR CONSEQUENTIAL DAMAGES - TO THE MAXIMUM EXTENT PERMITTED BY LAW, THE WARRANTY PROVIDED IN THIS DOCUMENT IS THE SOLE AND EXCLUSIVE WARRANTY PROVIDED BY luminage TO THE PRODUCT AND IT REPLACES ANY REPRESENTATION AND/ OR WARRANTY INCLUDING FITNESS FOR ANY PARTICULAR USE AND MERCHANTABILITY.

guarantee and service

Packaging and shipment costs of the defective product shall be paid by the purchaser of the product and return packaging and shipment shall be paid by Illuminage except in the event Illuminage shall determine that the product is not defected or not under warranty, in which case the packaging and shipping costs shall be with the purchaser of the product.

manufacturer information

The mē system is manufactured by Illuminage Beauty Ltd. Illuminage Beauty reserves the right to make changes to its products or specifications to improve performance, reliability, or manufacturability. Information furnished by Illuminage Beauty is believed to be accurate and reliable. However, Illuminage Beauty assumes no responsibility for its use. No license is granted by its implication or otherwise under any patent or patent rights of Illuminage Beauty. No part of this document may be produced or transmitted in any form or by any means, electronic or other, for any purpose, without the express written permission of Illuminage Beauty.

Illuminage Beauty has patents and pending patent applications, trademarks, copyrights, or other intellectual property rights covering subject matter in this document. The furnishing of this document does not give any license to these patents, trademarks, copyrights, or other intellectual property rights except as expressly provided in any written agreement from Illuminage Beauty. Specifications are subject to change without notice.

For more information about the mē system, contact Customer Support at www.mepower.com

Note: System design may change without prior notification

manufacturer information

Labels And Symbols

The nameplate label is adhered to the bottom of your mē system. It displays the manufacturer's name & address, the system's part & LOT numbers, electrical requirements and regulatory standards that the system is designed to comply with.



WEEE - Waste Electrical and Electronic Equipment



Follow operating instructions



Class II equipment



Degree of protection against electric type BF applied part



Do Not use in wet environment



CE Mark

Degree of protection against ingress water: IPX2; IP22

This device is not suitable for use in the presence of flammable anesthetic mixture with air or with Oxygen or Nitrous Oxide.

manufacturer information

- Light spectrum: 550 – 1200 nm
- Max Optical: 4J/cm²
- RF Wave frequency: 6.78 MHz
- Max Radiofrequency power: 5 Watts
- Pulse Light repetition rate: up to 1.1 Hz (1 pulse every 0.9 second)
- Plug configuration: UK, AU, EU, US
- Applicable Standards:

Safety Standards

- IEC/EN 60335-1:2010 5th Ed. / 2012
- EN 60335-2-8:2003+A1:2005+A2:2008
- EN 60335-2-23: 2003
- EN 60335-2-27: 2010
- IEC 60601-1:2005 3rd Ed. / EN 60601-1:2006 3rd Ed.
- IEC 60601-1:1988+A1:1991+ A2:1995 2nd Ed. / EN 60601-1:1990+A1:1993+A2:1995+A13:1996 2nd Ed.
- IEC 60601-1-11:2010
- SI 900 part 1:2006; part 2.8:2001; part 2.23:2009

EMC Standards

- EN 61000-6-1:2007
- EN 61000-6-3: 2007+A1:2011
- EN 61000-3-2: 2006+A1:2009+A2:2009
- EN 61000-3-3:2008
- EN 61000-3:2008
- IEC 60601-1-2: 2007

Biocompatibility

- ISO 10993-1:2010

MISC Standard

IEC 62301 2nd Ed. 2011-01;

Electrical Rating: 100-240 VAC, 50-60 Hz

Dimensions and weight 20.5 x 15 x 9 cm [W x L x H] 1.17 Kg

manufacturer information

EN

Acceptable Environmental Conditions

Note: The system will not operate in a room with temperature above 86°F (30°C). If system was stored in high humidity, let it dry for an hour before usage

Acceptable Environmental Conditions

Storage and transportation

Temperature	10°C - 55°C (50°F- 131°F)
Humidity	90% at 55°C (131°F)
Pressure	700-1060hPa

Operation:

Temperature	10°C - 30°C (50F- 86°F)
Relative Humidity	up to 80% at 37°C (99°F)
Altitude	up to 3900 m (13,000 ft)

contact information

If you have any problems using the mē system or would like more information about the mē system, contact Customer Support at www.mepower.com